

Assembly and Installation Instructions

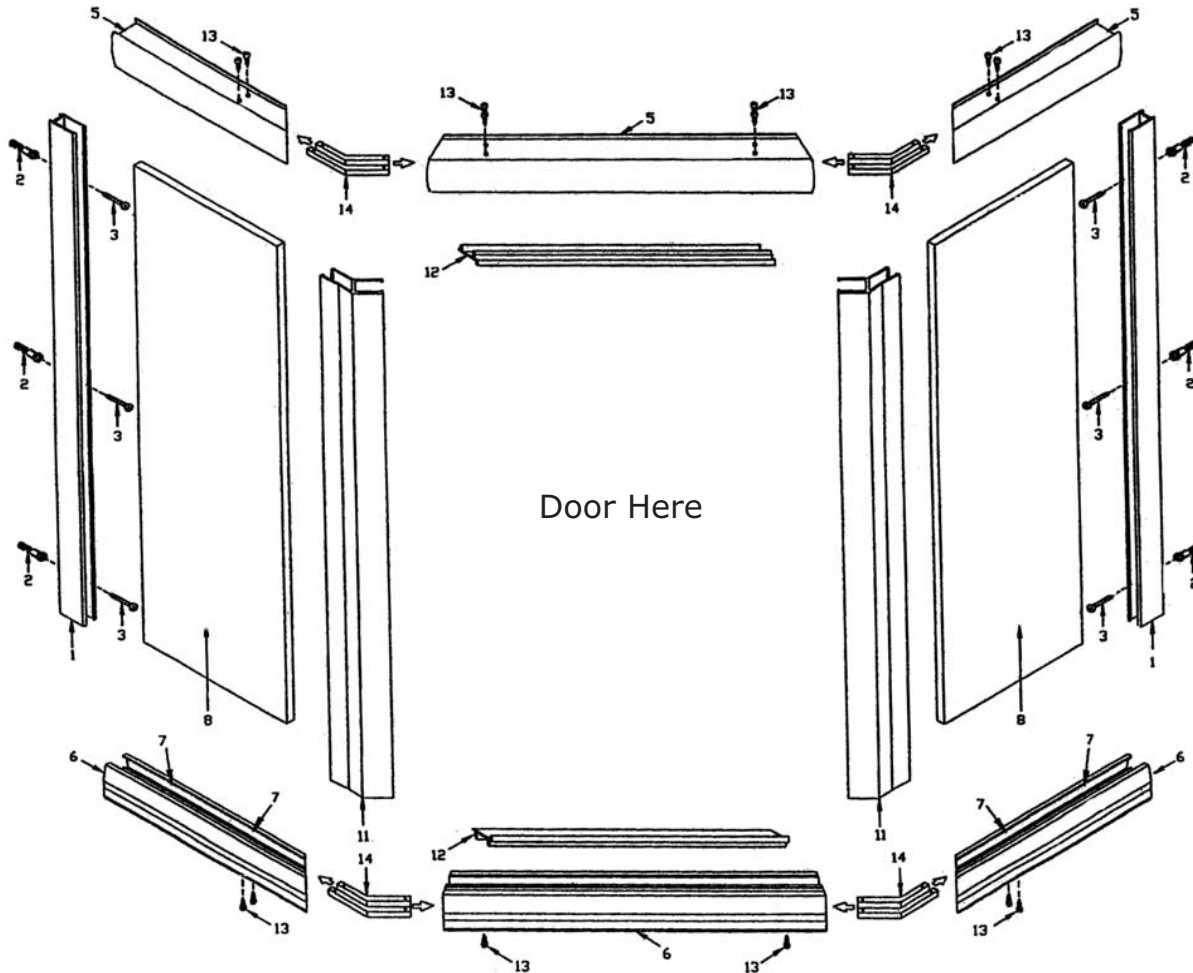

PREMIER SHOWER ENCLOSURE MPSS11135

- For assembly you will need:
1. Phillips Screwdriver
 2. Hack Saw
 3. Silicone
 4. Glazing Block
 5. 3/16" Carbide Drill Bit (for tile walls)
 6. Level
 7. #31 Drill Bit



When Ordering Repair Parts, Please Give The Following Information:

1. Model Number
2. Part Number
3. Part Description
4. Color

* Note: Number 1, 2 & 3 come with the door stall wrap

Description	Qty.	Part #	Picture
1. Wall Channels *	2	MD11006	
2. Wall Anchors *	6	ANCHOR	
3. #8 x 1 1/2" SMS Screws *	6	MBG8112-SM	
4. #6 x 3/8" SMS Screws	12	MBG638-SM	
5. Headers - Mitered 22.5 degrees	3	MSS-1701	
6. Curbs - Mitered 22.5 degrees	3	MSS-1101	
7. Glass Support Blocks	4	MV-902	
8. 135-Degree Glass Panels	2	Glass Side Panel	
9. Vertical Seal Vinyl	8	MV-909	
10. Horizontal Seal Vinyl	4	MV-906	
11. 135-Degree Posts	2	MSS-1105	
12. Header and Curb Fillers	2	MSS-1102	
13. #6 x 1/4" SMS B Screws	16	MBG614-SM	
14. 135-Degree Header / Curb Clips	8	MBG135-1043	

Assembly and Installation Instructions



Note: Wall channels (1), wall anchors (2), screws (3) that are used in stall shower installation are shipped with shower door. Read both door and stall installation instructions before starting installation.

1. Add 3/8" to centerline measurement for center section, and 3/16" to centerline measurements for sides. Cut both header and curb center sections to size, also cut the curb side sections for latter.
2. Assemble header and curb with clips provided (Figure 1). Using holes provided in header and curb, use a #31 drill bit to drill holes into clips. Secure using eight #6 x 1/4" SMS Screws (13). Set curb in place and mark location on curb, leaving curb in place temporarily.
3. Set wall channels into curb and mark holes on wall. Remove wall channels and curb. Drill holes into wall using 3/16" drill bit. Place screw anchors into holes.
4. Run a 1/4" bead of silicone on underside of curb, over miters, and where the ends of the curb sit on the threshold.
5. Replace the curb and silicone where miters are and where curb meets wall. Replace the wall channels and secure using #8 x 1 1/2" SMS.
6. Place glass-support blocks in curb and set panel glass in place, tacking at top with about 6" of the vertical seal vinyl. To adjust for wall conditions adjust the panel in or out of the post, making sure that at least 1/4" remains in each channel.
7. Place corner post in place over the edge of glass and tack in place using vertical seal vinyl. Plumb corner post to the respective wall.
8. Check the chart for the door size, and obtain the range for the curb filler. If the distance between the wall channel and the corner post falls within this range then cut curb filler to size. If the measurement does not fall into the range then a larger or smaller door is needed. Cut curb filler to size and snap in place with higher lip to outside of unit.

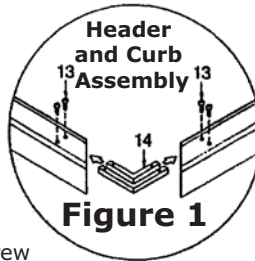

9. To cut header sides to length, measure for wall to the outside point of angle on corner post, and then add 1/8" to this measurement. This is the length of the outside dimension of the header from miter point to the wall.

(Refer to Shower Door Installation Instructions)

10. Snip excess vinyl from latch jamb and crimp in place at the top and bottom. Holding corner post, slip latch jamb in place.
11. Install 3" vinyl channel, centered on edge of door glass and tap handle in place.
12. Set door (with hinge jamb attached) over corner post. Secure hinge jamb to corner post using adjustment derived from step #8. Use a #31 drill bit and #6 x 3/8" SMS.
13. Stand inside shower and pull door closed. If, when you pull the door closed without creating pressure on the latch jamb vinyl, there is an opening at the top, you must decrease the length of the header over the fixed panel side where the door is hanging. If the gap is at the bottom then you need to shorten the length of the header over the fixed panel where the door latches.
14. Using a #31 drill and #6 x 3/8" SMS, secure header to wall channels.
15. Adjust header up or down on corner post to make parallel with top of door. Now using a #31 drill secure with #6 x 3/8" SMS to the corner post.
16. Install rest of vertical seal vinyl at post and wall channels, and horizontal seal vinyl in header and curb.
17. Recheck alignment of door and corner post; if out of alignment adjust by tapping on corner post.
18. Adjust splash vinyl so that approximately 1/8" daylight space remains between bottom of the splash vinyl and curb filler with the door in the closed position.
19. Seal along inside and outside edge of metal and tile with silicone.

Header & Curb Fillers		
Min. Filler = Door Size - 1 7/8"		
Max Filler = Door Size - 7/8"		
Model Number	Min.	Max.
MD-1000-20	18 1/8"	19 1/8"
MD-1000-21	19 1/8"	20 1/8"
MD-1000-22	20 1/8"	21 1/8"
MD-1000-23	21 1/8"	22 1/8"
MD-1000-24	22 1/8"	23 1/8"
MD-1000-25	23 1/8"	24 1/8"
MD-1000-26	24 1/8"	25 1/8"
MD-1000-27	25 1/8"	26 1/8"
MD-1000-28	26 1/8"	27 1/8"
MD-1000-29	27 1/8"	28 1/8"
MD-1000-30	28 1/8"	29 1/8"
MD-1000-31	29 1/8"	30 1/8"
MD-1000-32	30 1/8"	31 1/8"
MD-1000-33	31 1/8"	32 1/8"
MD-1000-34	32 1/8"	33 1/8"
MD-1000-35	33 1/8"	34 1/8"
MD-1000-36	34 1/8"	35 1/8"

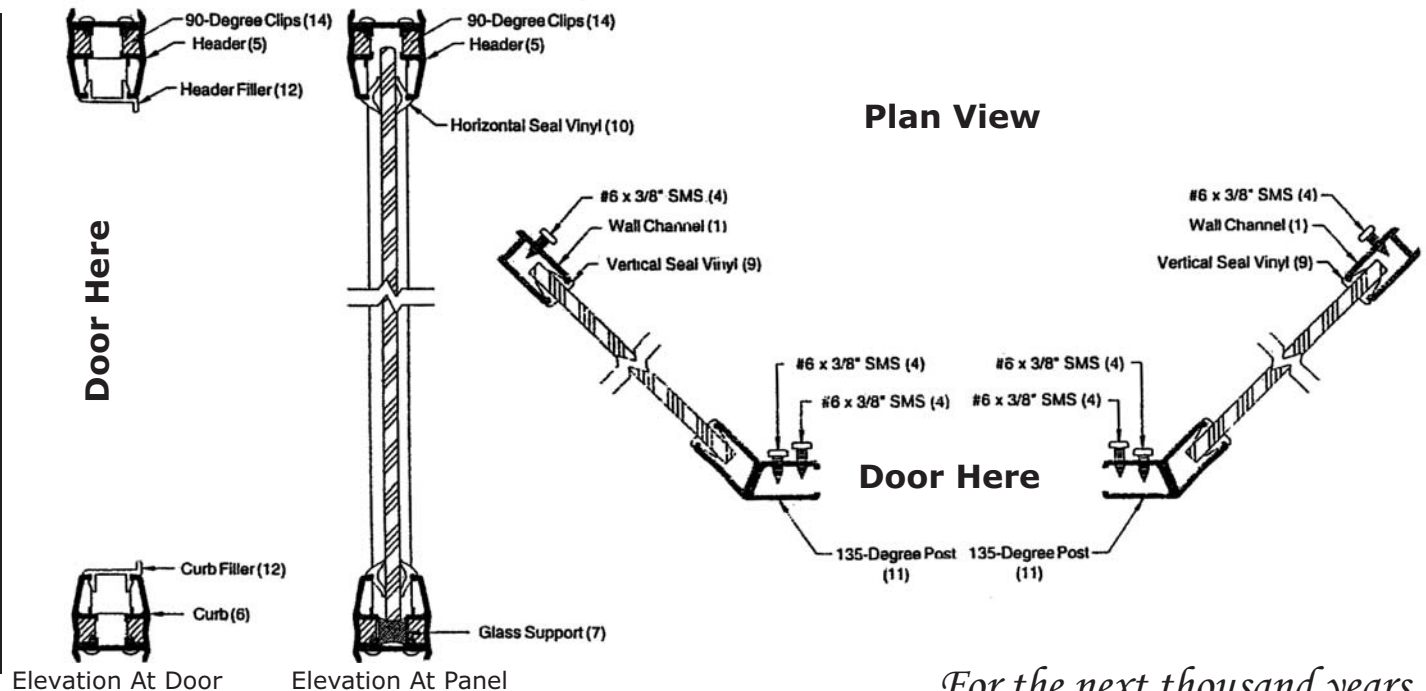

For the next thousand years.